

Cartridge Replacement Steps:

1. Remove all decorative trim to gain access to front of the valve.
2. Shut off the water inlets by tightening the two screws at the two valve inlets (6).
3. Unscrew the Nipple and Stem assembly (5) using a 32mm socket wrench or an adjustable wrench in a counter-clockwise direction and gently pull off.
4. Unscrew the retainer nut (4) using a 38mm socket wrench or an adjustable wrench in a counter-clockwise direction and remove.
5. Gently pull out the Pressure Balance cartridge (2) from the valve body (1) and replace.
NOTE: If necessary, configure the limit-stop (3) on the new cartridge identical to that of the previous cartridge. Additionally, rotate the cartridge stem fully clockwise to close the valve.
6. Reassemble the valve by reversing these instructions.
7. Turn water back on and test valve before re-installing decorative trim.

SS-PB85 Diverter Cartridge (PARTS 7-11):

1. Unscrew diverter knob (10), diverter stem (8), and diverter knob adapter (9) gently by hand.
2. If applicable, unscrew the attachment nut (11) using a 22mm socket wrench or an adjustable wrench in a counter-clockwise direction and set aside.
3. Unscrew the diverter cartridge using a 13mm socket wrench or an adjustable wrench in a counter-clockwise direction and replace.
4. Test diverter valve before re-installing decorative trim.

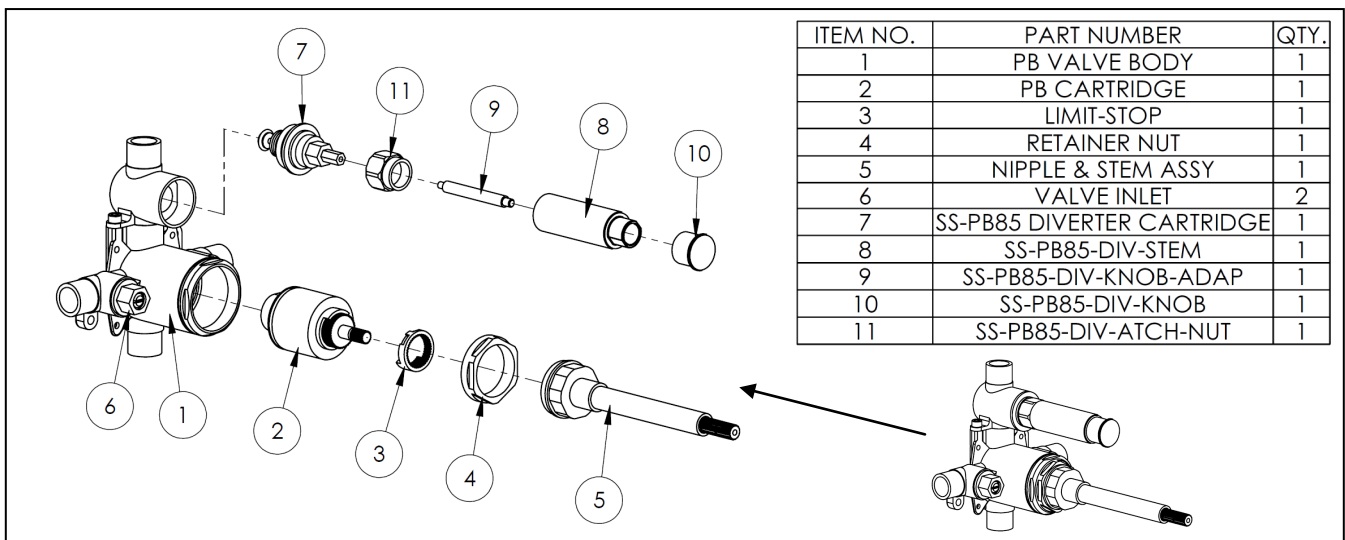

RETURN POLICY

All cartridges are shipped in a clear plastic bag, so you can examine it carefully upon receipt. If the part is not correct, you can return it for a full refund less freight as long as the bag is unopened. Once the bag is opened, the cartridge can only be returned for credit if deemed defective and is accompanied with original proof of purchase (not the replacement order.)

For technical support, please call 718-257-2800